

Current part is item (2) on diagram. Available at www.oshkoshequipment.com

(1) (a) FIG. NO.	(2) (b) ITEM NO.	(3) SMR CODE	(3) NATIONAL STOCK NUMBER	(4) PART NUMBER	(5) FSCM	(6) DESCRIPTION USABLE ON CODE	(7) U/M	(8) QUAN. INC IN UNIT
GROUP 47-GAGES(NON-ELECTRICAL), WEIGHING AND MEASURING DEVICES								
4701-INSTRUMENTS								
344	1	PAOZZ	5310-00-959-7600	MS51922-5	96906	NUT, SELF-LOCKING AB, AC	EA	3
344	2	PAOZZ	5305-00-068-0505	MS90726-5	96906	SCREW, CAP, HEXAGON HEAD AB, AC	EA	3
344	3	PAOZZ	5340-00-088-1254	MS21333-104	96906	CLAMP, LOOP AB, AC	EA	3
344	4	PAOZZ	6680-00-732-0561	MS51071-5	96906	SHAFT ASSEMBLY, FLEXIBLE: TACHOMETER TO ENGINE DRIVE ADAPTER AB, AC	EA	1
344	5	PAOZZ	5310-00-753-9688	7539688	19207	WASHER, FLAT: SEALING AB, AC	EA	1
344	6	PAOZZ	5310-00-532-9467	5329467	19207	WASHER, SLOTTED AB, AC	EA	1
344	7	PAOZZ	5330-00-753-9689	7539689	19207	GASKET: GEAR COVER TO TACHOMETER DRIVE PLUG AB, AC	EA	1
344	8	PAOZZ	6680-00-882-0961	MS51072-5	96906	CORE FLEXIBLE, SHAFT ASSEMBLY: TACHOMETER DRIVE SHAFT AB, AC	EA	1
344	9	PAOZZ	5325-00-174-9038	MS35489-20	96906	GROMMET, RUBBER AB, AC	EA	1
344	10	PAOZZ	6680-00-825-2076	MS35916-2	96906	TACHOMETER, MECHANICAL, FIXED MOUNTING AB, AC	EA	1
344	11	PAOZZ	5310-00-934-9751	MS35650-302	96906	NUT, PLAIN, HEXAGON AB, AC	EA	2
344	12	PAOZZ	5310-00-045-3296	MS35338-43	96906	WASHER, LOCK AB, AC	EA	2
344	13	PAOZZ	7690-00-924-4318	10932058	19207	DECAL: TACHOMETER WARNING DANGER AB, AC	EA	1
345	1	PAOZZ	5330-00-011-5449	115449	21450	GASKET: GEAR COVER TO TACHOMETER DRIVE ADAPTER AB, AC	EA	1
345	2	PAOZZ	6620-00-084-7621	10912497	19207	ADAPTER, TACHOMETER TAKE-OFF AB, AC	EA	1
345	3	PAOZZ	2815-00-995-1811	11610078	19207	ADAPTER ASSEMBLY, TACHOMETER: RIGHT ANGLE DRIVE AB, AC	EA	1
346	1	PAOZZ	2520-00-562-0421	7061216	19207	ADAPTER, ANGLE DRIVE, SPEEDOMETER: DRIVE RATIO 0.167 TO 1 (SAME AS ADAPTER, P/N 7065893 (19207), EXCEPT WHERE INDIVIDUAL COMPONENTS ARE ANNOTATED)	EA	1
346	1	PAOZZ	2520-00-404-3098	7065893	19207	ADAPTER, SPEEDOMETER: DRIVE RATIO 0.200 TO 1 (USED ON VEHICLES THROUGH SERIAL NO. 90802) (M34, M44, M47, V17A/MTQ, V18A/MTQ)	EA	1
346	2	PAOZZ	2520-00-737-2729	7372729	19207	SHAFT, DRIVE, SPEEDOMETER: SLIDING, DRIVE ADAPTER (USED ON ADAPTER, P/N 7065893 (19207), ONLY)	EA	1
346	2	PAOZZ	2520-00-706-5894	7065894	19207	SHAFT, SPEEDOMETER ADAPTER: SLIDING, DRIVE ADAPTER (USED ON ADAPTER, P/N 7061216 (19207), ONLY)	EA	1

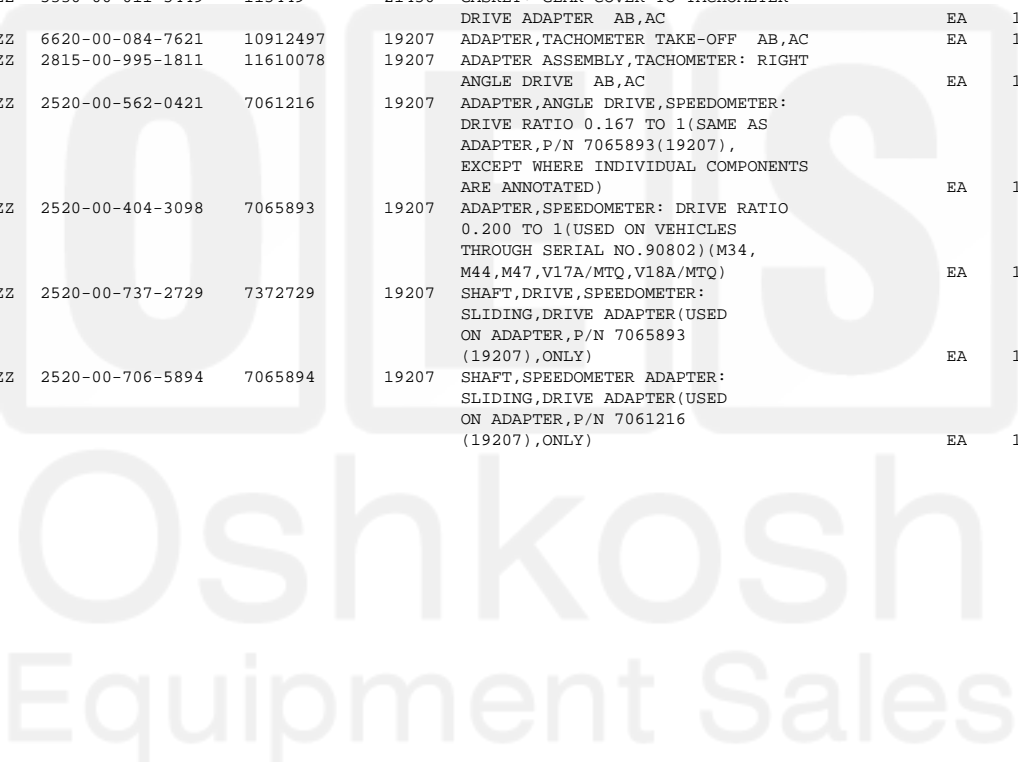

Current part is item (2) on diagram. Available at www.oshkoshequipment.com

TM 9-2320-209-201

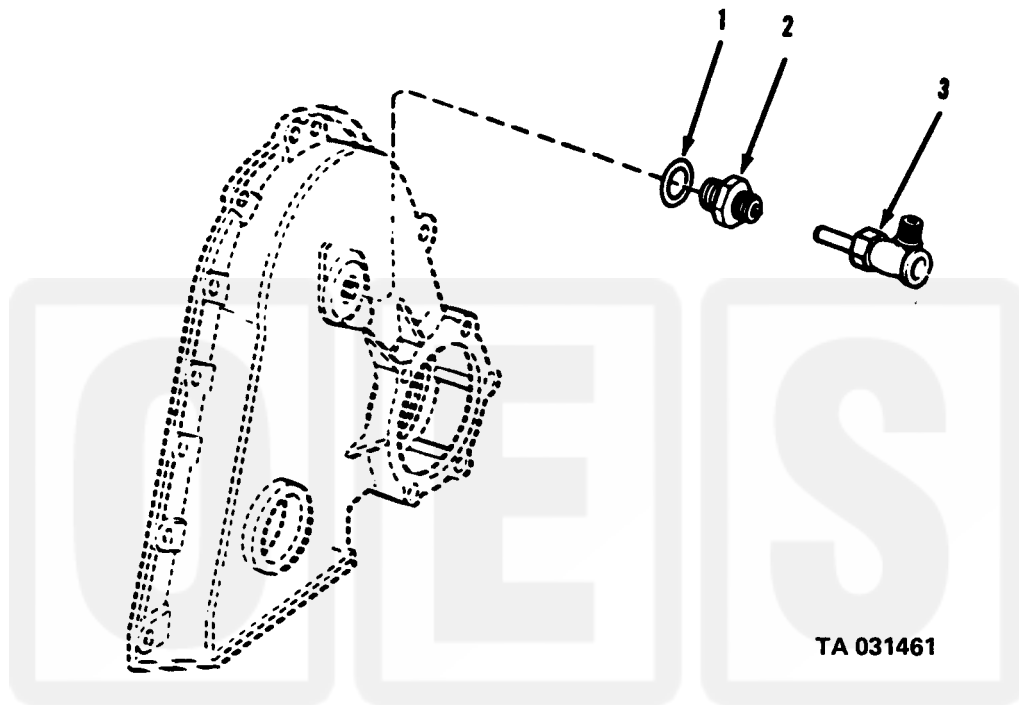

Figure 345. Tachometer drive and take-off adapter.

Oshkosh
Equipment Sales